

Due to slight differences in land level under the bottom steel you may have gaps between wall panels. These can and should be closed so that you have a tight, closed seam at each joint where panels meet. This is done by prying up on the panels or occasionally,

prying up on the bottom steel where it may be low. The gaps are exaggerated in this diagram for clarity's sake. If bottom steel is leveled to within 1 in. overall you should not have any trouble installing the water walls.

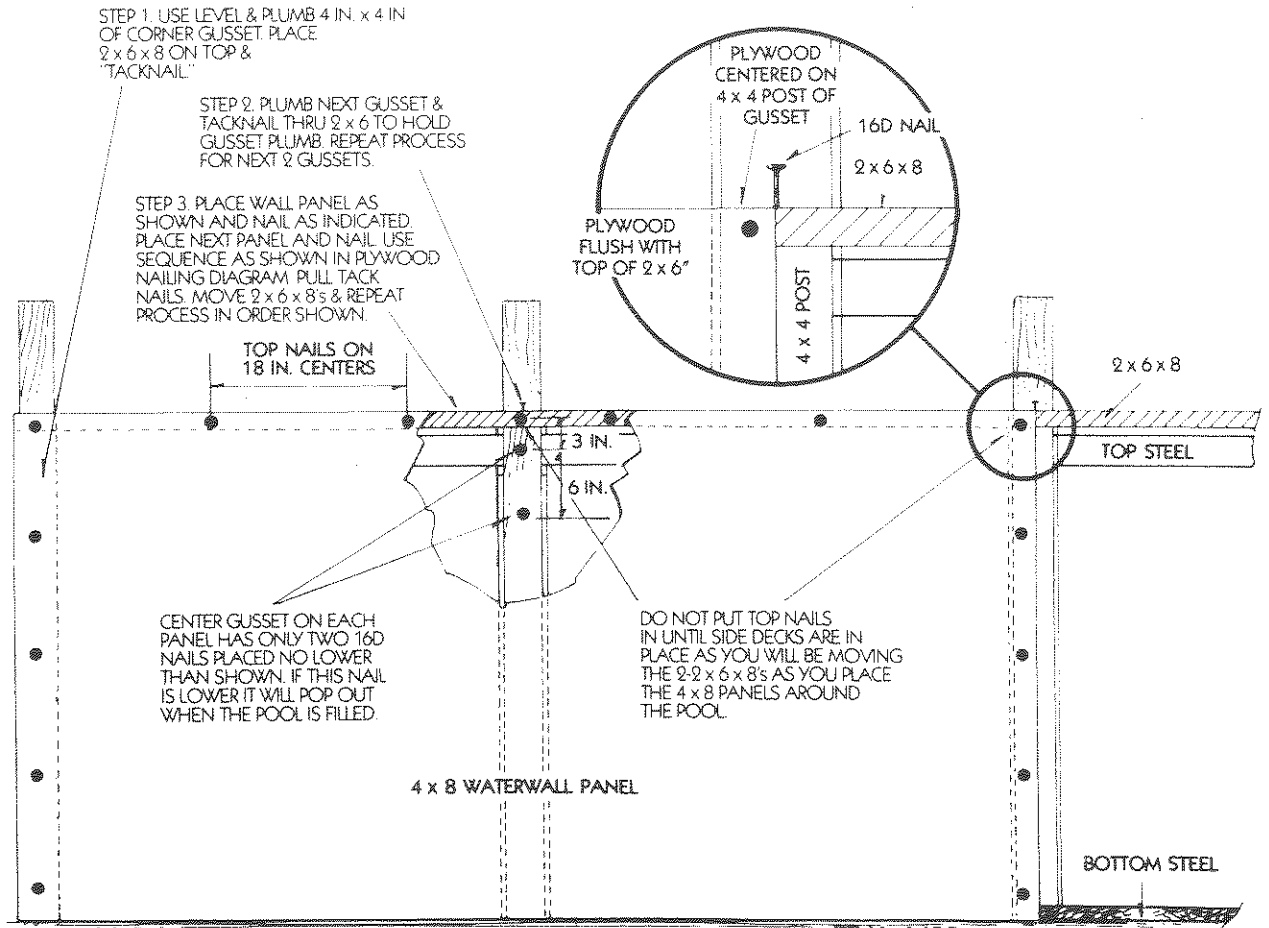

PLYWOOD NAILING SEQUENCE 16 x 24

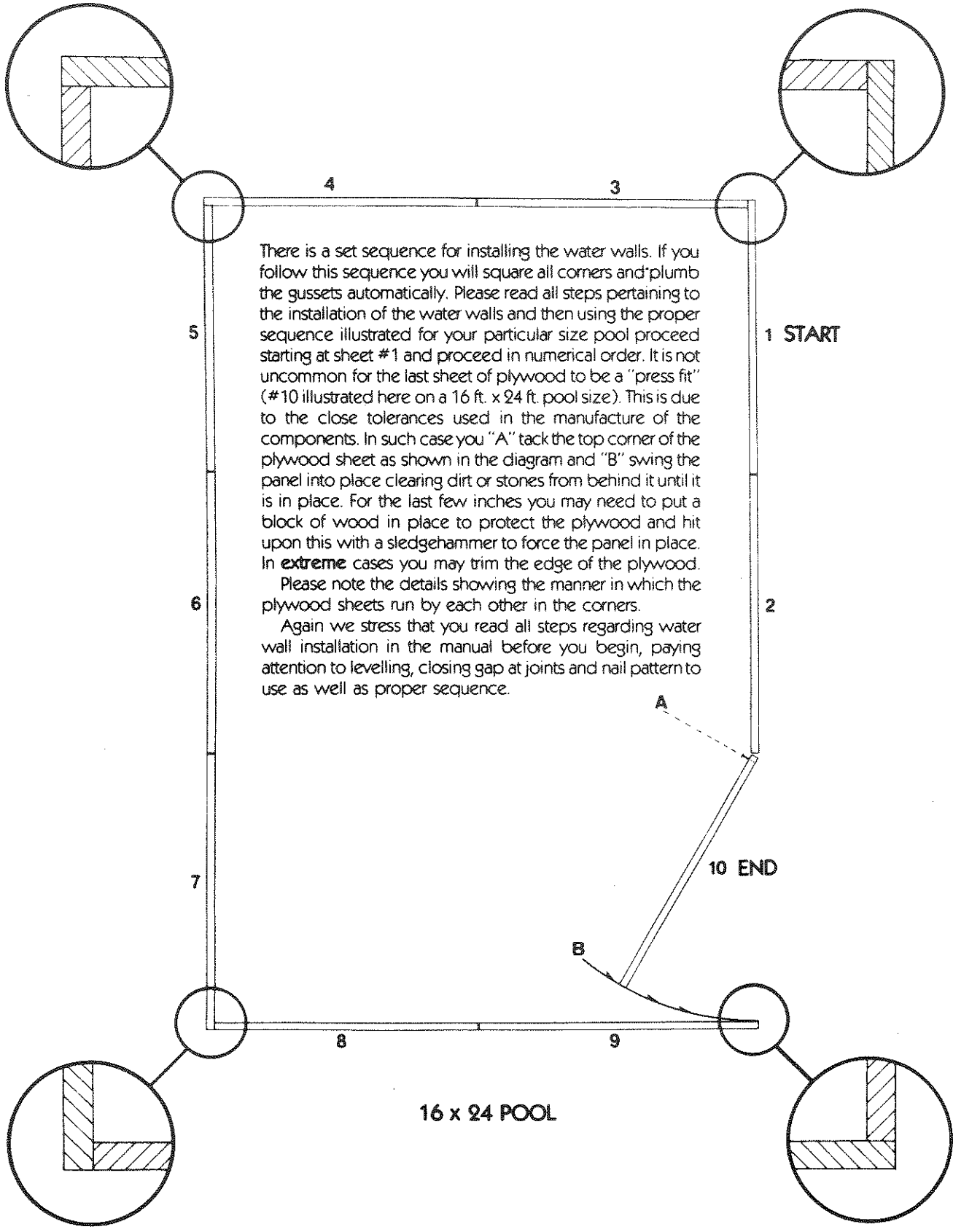

There is a set sequence for installing the water walls. If you follow this sequence you will square all corners and plumb the gussets automatically. Please read all steps pertaining to the installation of the water walls and then using the proper sequence illustrated for your particular size pool proceed starting at sheet #1 and proceed in numerical order. It is not uncommon for the last sheet of plywood to be a "press fit" (#10 illustrated here on a 16 ft. x 24 ft. pool size). This is due to the close tolerances used in the manufacture of the components. In such case you "A" tack the top corner of the plywood sheet as shown in the diagram and "B" swing the panel into place clearing dirt or stones from behind it until it is in place. For the last few inches you may need to put a block of wood in place to protect the plywood and hit upon this with a sledgehammer to force the panel in place. In **extreme** cases you may trim the edge of the plywood.

Please note the details showing the manner in which the plywood sheets run by each other in the corners.

Again we stress that you read all steps regarding water wall installation in the manual before you begin, paying attention to levelling, closing gap at joints and nail pattern to use as well as proper sequence.

16 x 24 POOL

PLYWOOD NAILING SEQUENCE
 12 x 20, 12 x 24, 8 x 32, 8 x 40

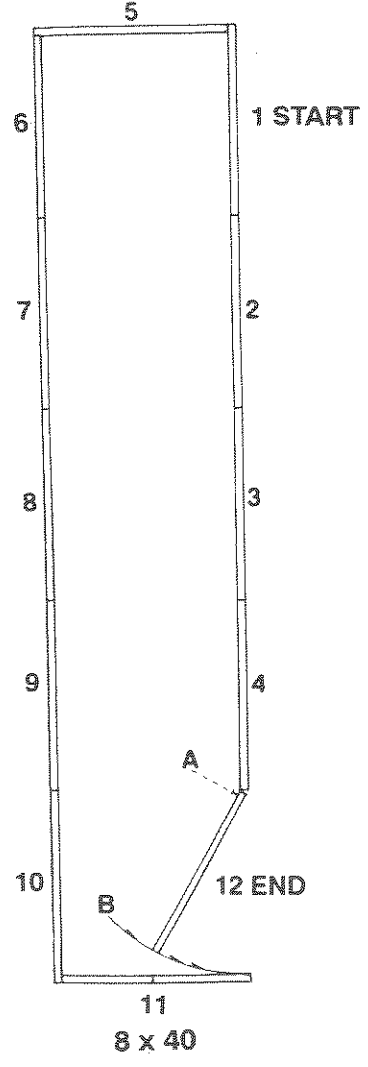
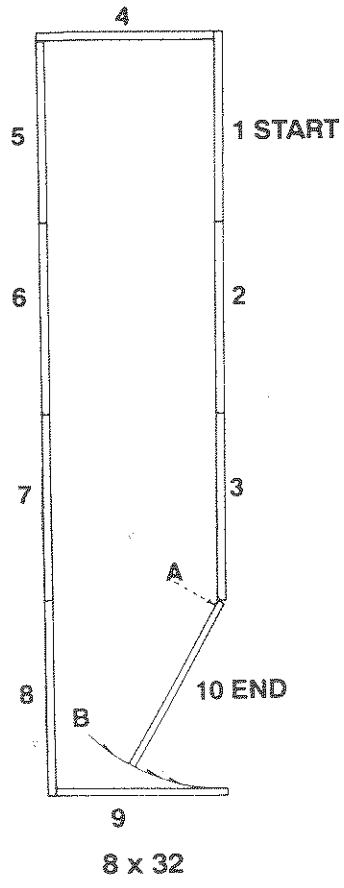
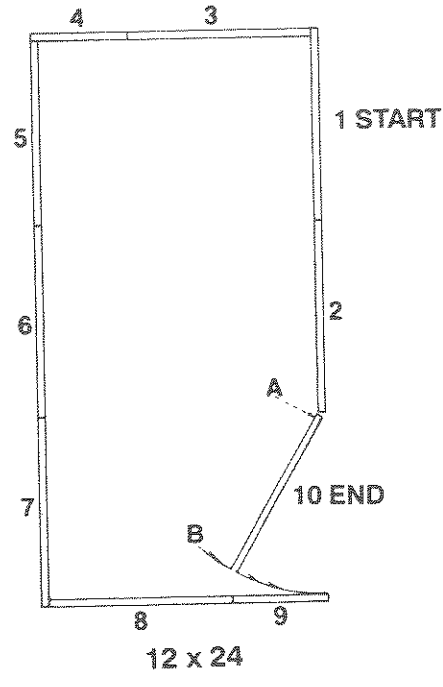
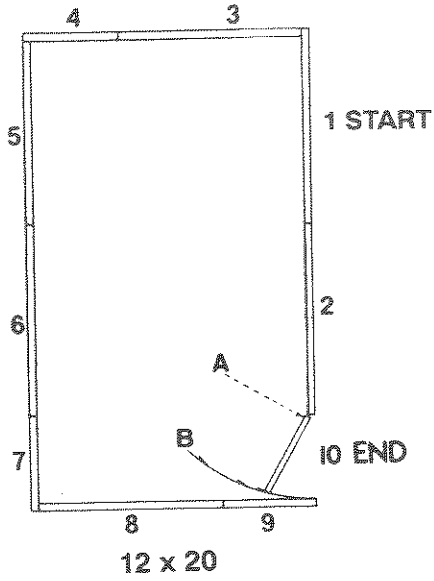

PLYWOOD NAILING SEQUENCE

12 x 32, 12 x 40

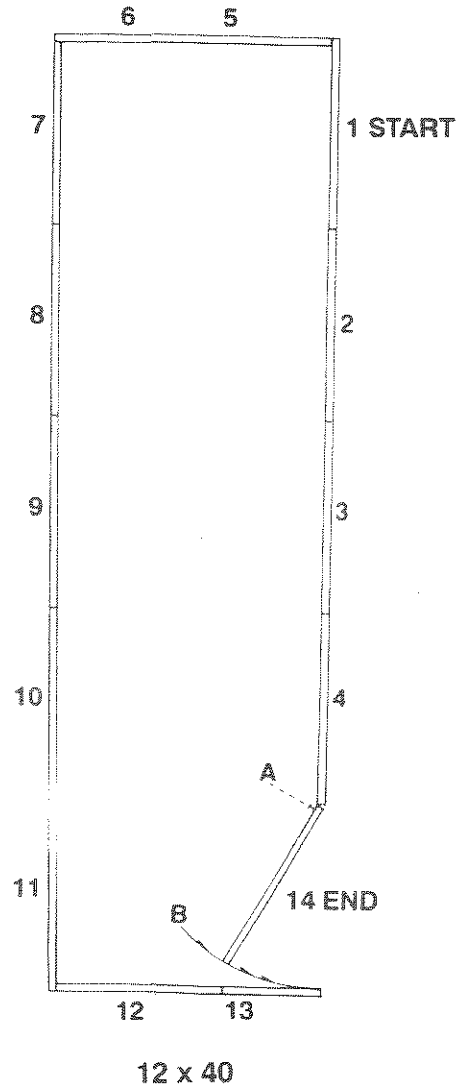
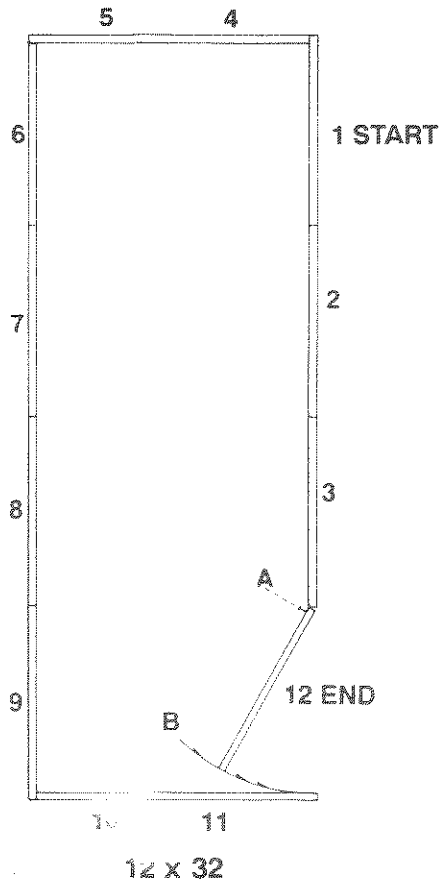

PLYWOOD NAILING SEQUENCE

16 x 32, 20 x 40

