

PARTS

<b>P1</b> x 1	<b>P2</b> x 1	<b>P3</b> x 2	<b>P4</b> x 2
---------------	---------------	---------------	---------------

HARDWARE

<b>1</b> x 2	<b>2</b> x 2	<b>3</b> x 2	<b>4</b> x 2	<b>5</b> x 4	<b>6</b> x 4	<b>7</b> x 4	
<b>8</b> x 4	<b>9</b> x 4	<b>10</b> x 2	<b>11</b> x 2	<b>12</b> x 2	<b>13</b> x 1	<b>14</b> x 1	<b>15</b> x 1

⚠ WARNING

- **NO JUMPING-NO DIVING** from ladder or platform, you can be permanently injured.
- **TO PREVENT ENTRAPMENT OR DROWNING**, keep a maximum of 4" between inner pool wall and ladder .
- **DO NOT REMOVE** or alter the ladder side barrier, entrapment or drowning might result.
- **DO NOT USE** 120V corded power tool when you assemble the ladder, serious injury might occur.
- **TO PREVENT DROWNING** watch children at all times when pool is in use.
- **CONSULT** your city for specific local regulations.
- **IMPORTANT SAFETY INSTRUCTIONS INCLUDED.** Read, follow and save these instructions.

⚠ CAUTION

- This ladder must **ONLY** be used for entry and exit of pool. Any other use might damage the product or void the warranty.
- To prevent damaging the ladder in winter time, stow away in a dry location.

TOOLS

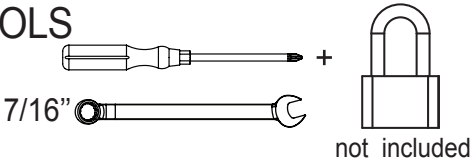

**STEP 1**  
Attach the two feet (1) onto the "U" shaped ladder base (P1) using the stainless steel screws (2), the stainless steel washers (3) and the plastic caps (4).

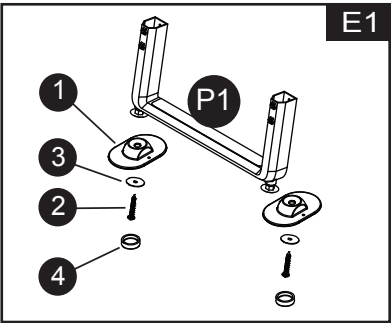

**STEP 2**  
Insert the ladder frame (P2) into the assembled base (E1). Adjust the height of P2 plus E1 to the height of the pool, 48", 52" or 54". Secure the ladder base (E1) to the ladder frame (P2) by inserting four bolts (5) into the four predrilled holes and fastening them with four washers (6) and four nuts (7).

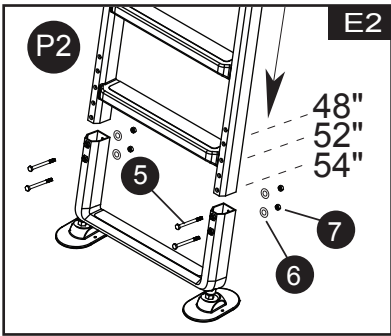

**STEP 3**  
**NOTE:** In this step, alignment is critical. Petroleum jelly may be used if necessary to make the fit easier. Insert the assembled ladder (E2) into the handrails (P3). Make sure that the locking pins located on either side of the ladder frame (E2) have snapped into place inside the handrails.

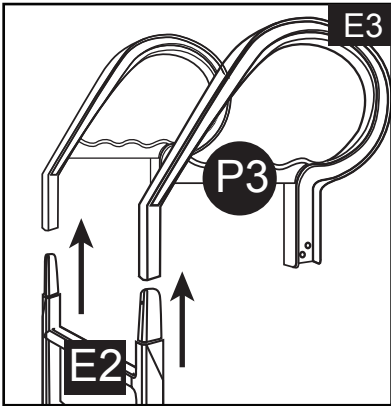

**STEP 4A**  
You have determined the height of the ladder in E2 based on the height of the pool (48", 52" or 54"). Using a solid table with a square edge snap off the excess plastic on the two largest protective side barriers (12) for a 48" or 52" pool height. Nothing need be done for a 54" pool height.

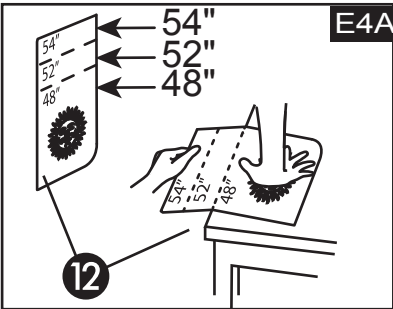

**STEP 4B**  
Insert both the adjusted (E4A) large protective barriers (one each side) at the bottom of the ladder frame assembly (E3). Insert a step extension (13) into the ladder frame (E3) making sure that both side barriers (12) are completely inserted in the step (13) and that the locking pins on the step (13) have snapped into place.

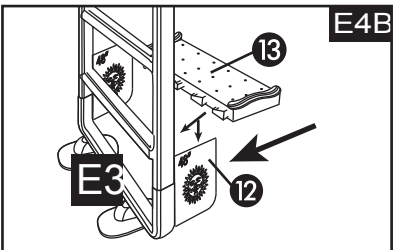

**STEP 4C**  
First, slide a pair of protective barriers (11) into the previously installed step (13). Then insert the next step (13) into the frame of the ladder and the barriers (11). Make sure that the barriers are properly installed and the locking pins on the step have snapped into place. Repeat with the two remaining barriers (11) and the smallest step (14). Make sure that the barriers are properly installed and the locking pins on all steps have snapped into place.

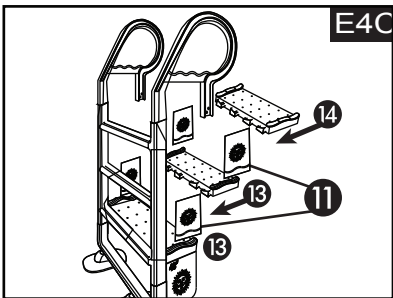

**STEP 5**  
**WARNING**  
Insert the bases (P4) into the ends of the handrails. Determine the placement of the bases on the platform by making sure that the space between the pool's inner wall and the ladder is 4". **TO PREVENT ENTRAPMENT OR DROWNING**, keep a maximum of 4" between inner pool wall and ladder.

