

Stainless Steel Cover Reel Set

1

Ref.	Description
A	Short Tube with Axles
B	Short T Frame
C	Threaded Screw
D	Long Tube with Caps
E	Long T Frame
F	Crank
G	Wheels
H	Grip
I	Connector
J	Long Hub
K	Short Hub
L	Strap with Female Velcro
M	Male Velcro Sticker
N	Buckle
O	Cover Clip
P	Self Tapping Screw
Q	Screw
R	Frame Assembly Nut & Bolt
S	Nut & Screw
T	Wheel Retaining Ring
U	Grip Washer
V	Nut & Screw

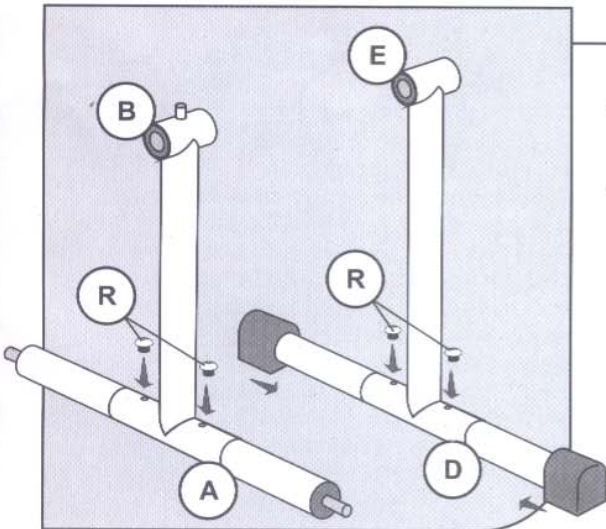
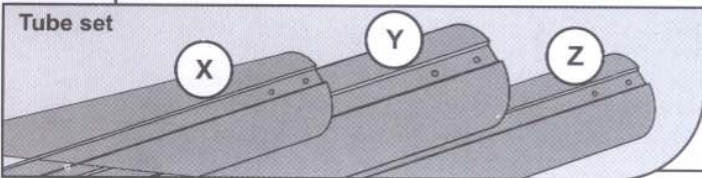
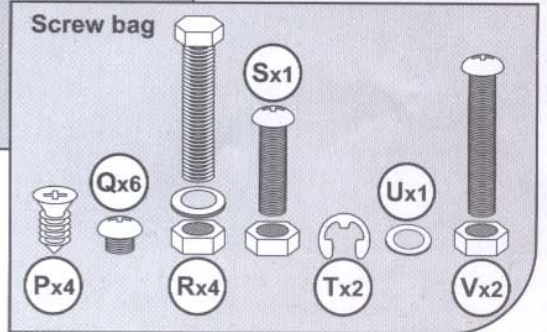
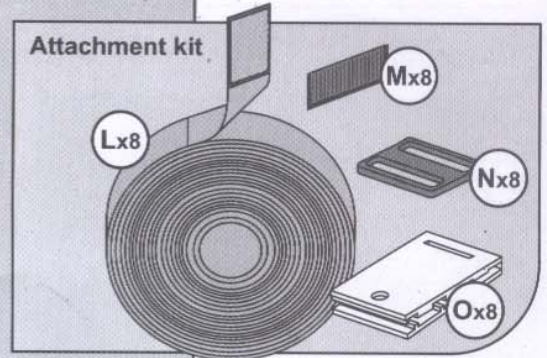
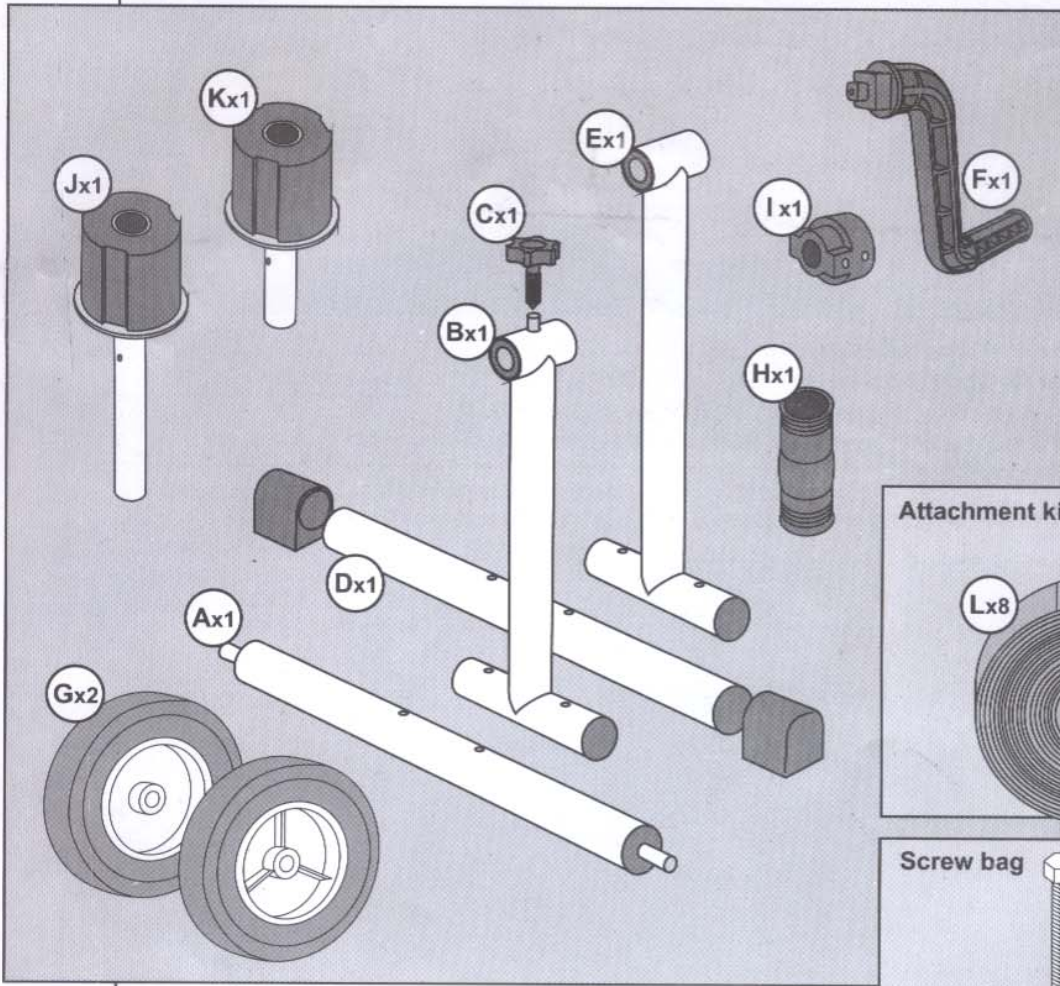

- Slide the short tube "A" into the tube at the bottom of the T frame "B" and then secure them with nut and bolt "R".
- Repeat the same operation for the assembly of the long tube "D" to the T frame "E". Put the cap onto both ends of "D".

2

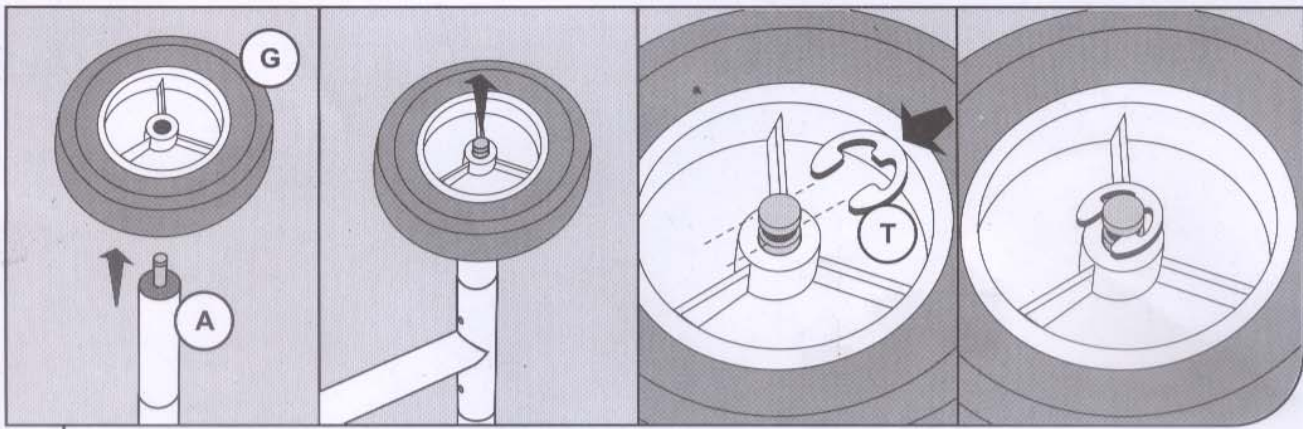

3

- Slide the wheel "G" onto the axis of the short tube "A".
- Put the retaining ring "T" over the wheel and align the hook end of retaining ring to the groove around axis.
- Use the screw driver to push the retaining ring completely down to the groove of the axis.
- Make sure the retaining ring is in place and the wheel is totally secured under the retaining ring before next step.

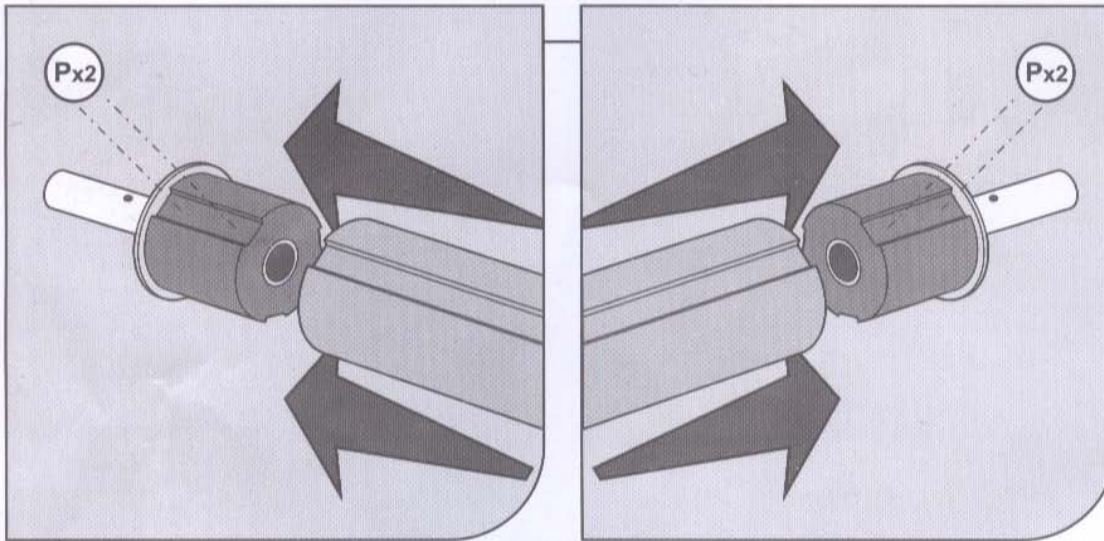

4

- NOTE:** Tube set comes with 3 sections "X/Y/Z". Two sections have same diameter (marked "X" & "Y") and one section has a bigger diameter (marked "Y"), which is to be placed in middle to connect sections "X" & "Z" on each side.
- Align the groove on the hub with pre-drilled holes on tube "X", and insert the short hub "K" into one end of tube "X". Secure the assembly with two self tapping screws "P".
 - Repeat the operation with the long hub "J" into one end of tube "Z" and secure the assembly with two self tapping screws "P".

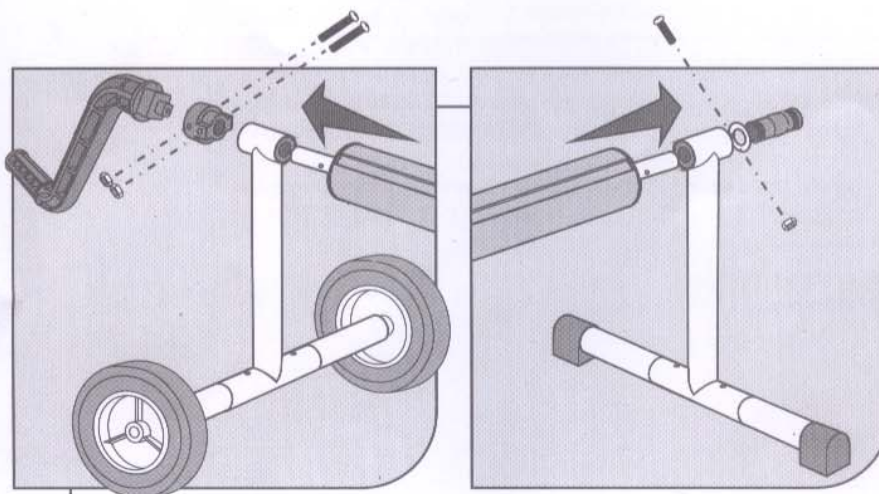

5

- Assemble the axle of short hub "K" onto the short T frame "B".
- Insert the crank "F" into the connector "I" and then secure with the screw and nut "V".
- Slide the crank (preassembled with the connector) onto the axle of the short hub "K" until connector hole matches the hole on the hub axle and then secure with the screw and nut "V".
- Assemble the axle of the long hub "J" onto the long T frame "E", place the washer "U" behind the frame. Put the screw of "S" through the hole on the hub axle and secure with the nut. Slide the grip "H" onto the hub axle.

6

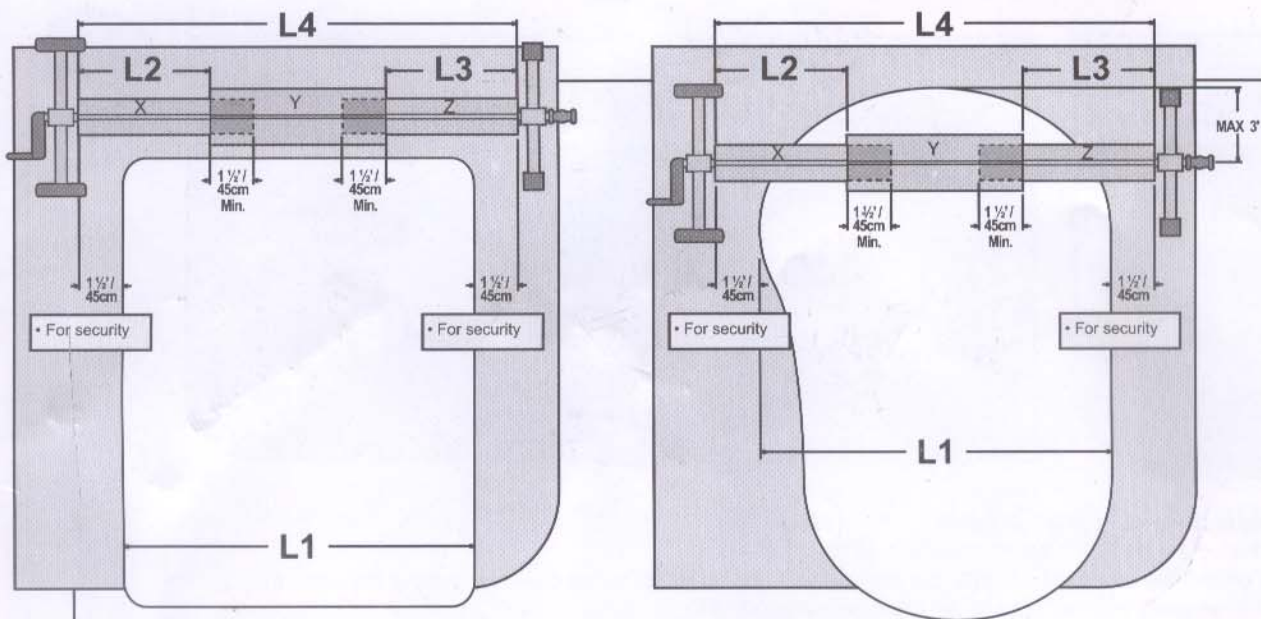

- Measure the maximum width of your pool (between the pool inner edge) = L1.
- Insert the tube "X" and "Z" into the tube "Y", and slide them until you have the required size + 1½ft (45cm) margin on right and left side of L1 as shown in above diagram.
- Ensure that the tube "Y" is exactly centered so that L2 and L3 are equal.
- Also ensure that there is a minimum tube overlap of 1½ft (45cm) on both sides of the tube "Y".

7

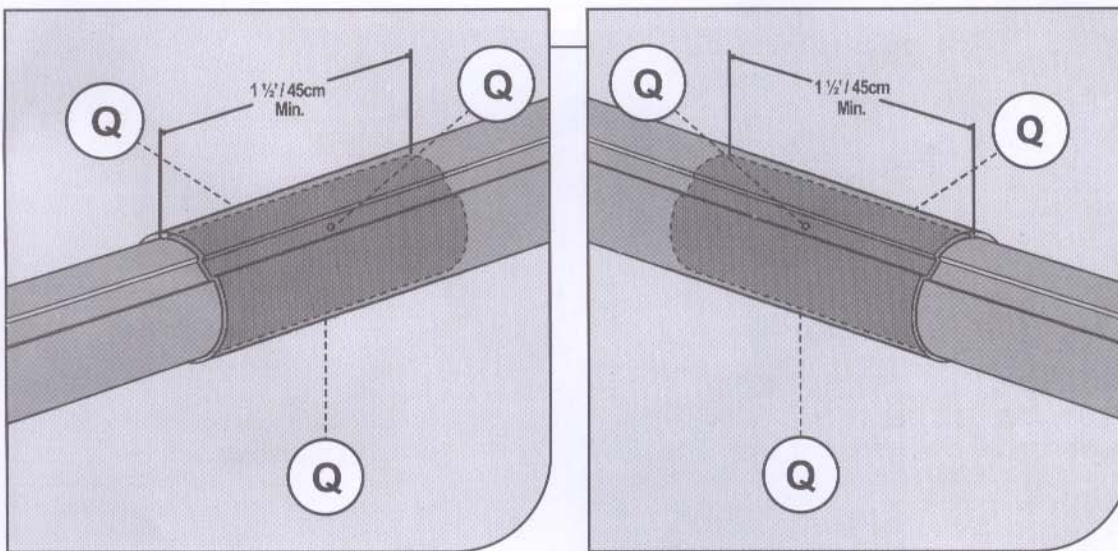

- Align the pre-drilled holes on tubes "X" and "Y", and on tubes "Y" and "Z" respectively and then fix the tube connection by fastening 3 screws "Q" into the pre-drilled holes.

8

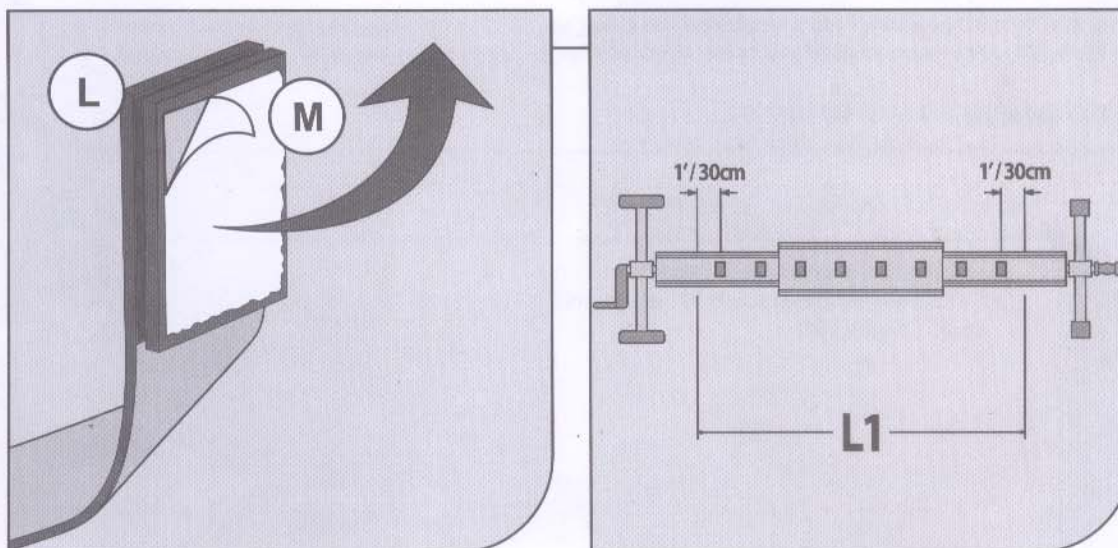

- Peel off the protective layer from the velcro sticker "M" and stick together with strap onto the tubes in a straight line at equal interval over the length L1 as shown.

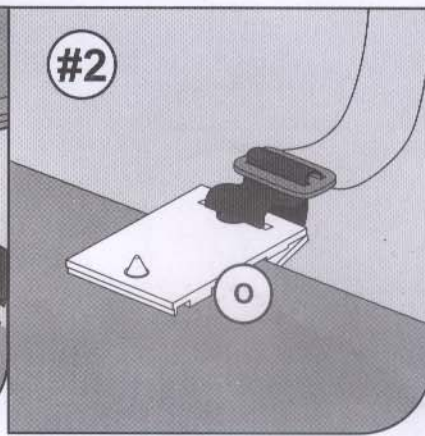
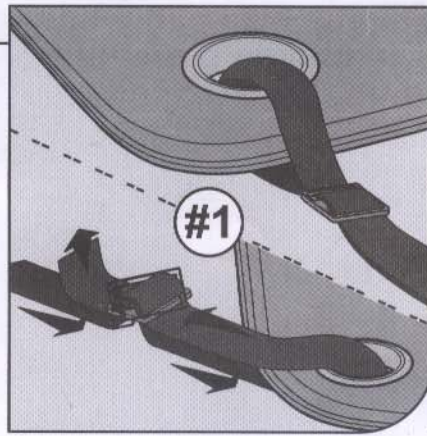
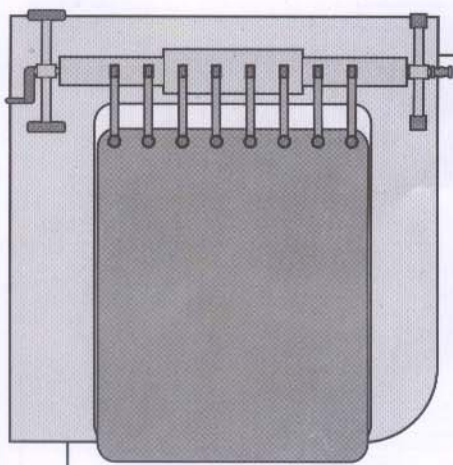

9

For rectangular shaped in ground pools

- Open cover over the pool and set into position.
- If you have grommets on the cover, you can attach the cover strap "L" to the cover by putting the strap through the grommet and securing with the buckle "N" provided (Diagram #1).
- If there are no grommets, you can attach the cover clip "O", after preassembling with the strap, by snapping onto the cover (Diagram #2). Make sure to position the clips along the cover at the same intervals as the straps will be attached to the tube.
- You can adjust the length of the strap by sliding the buckle.
- Ensure that the length of the straps allows the cover to lay flat on the pool to prevent wind from getting inside under the cover.

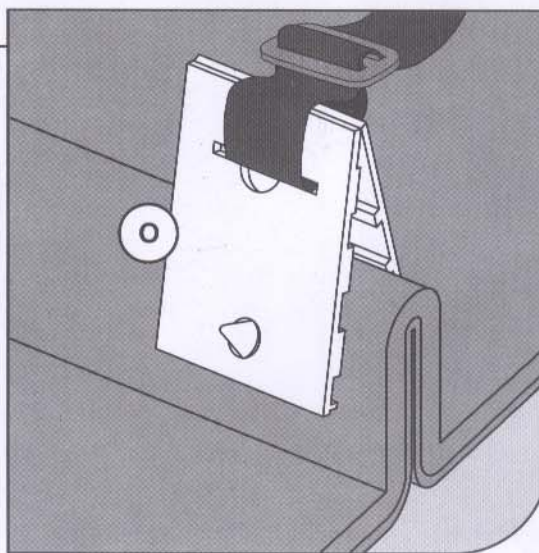
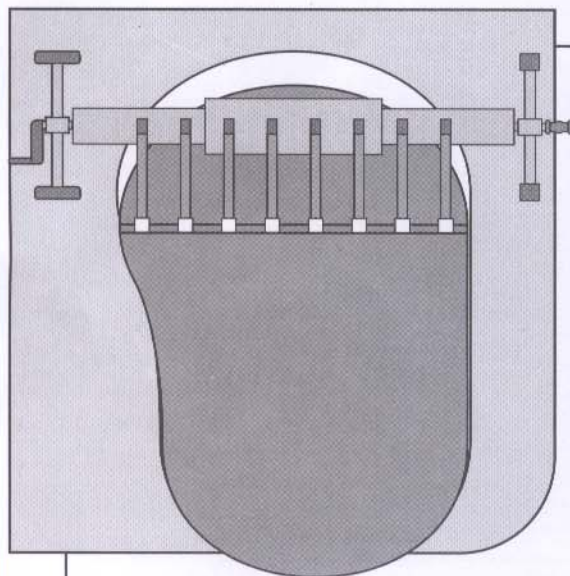

10

For round or oval shaped in ground pools

- Open cover over the pool and set into position. Fold an edge on the cover with a width sufficient for a cover clip assembly on it. Position the cover clips "O", after preassembling with the strap, along the cover at the same intervals as they will be attached to the tube.
- You can adjust the length of the strap by sliding the buckle.

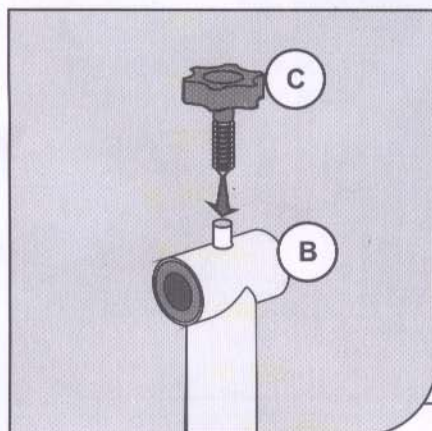

Locking the crank / reel in position

- Fasten the threaded knob "C" to the hole of the top of short T frame "B".

11