

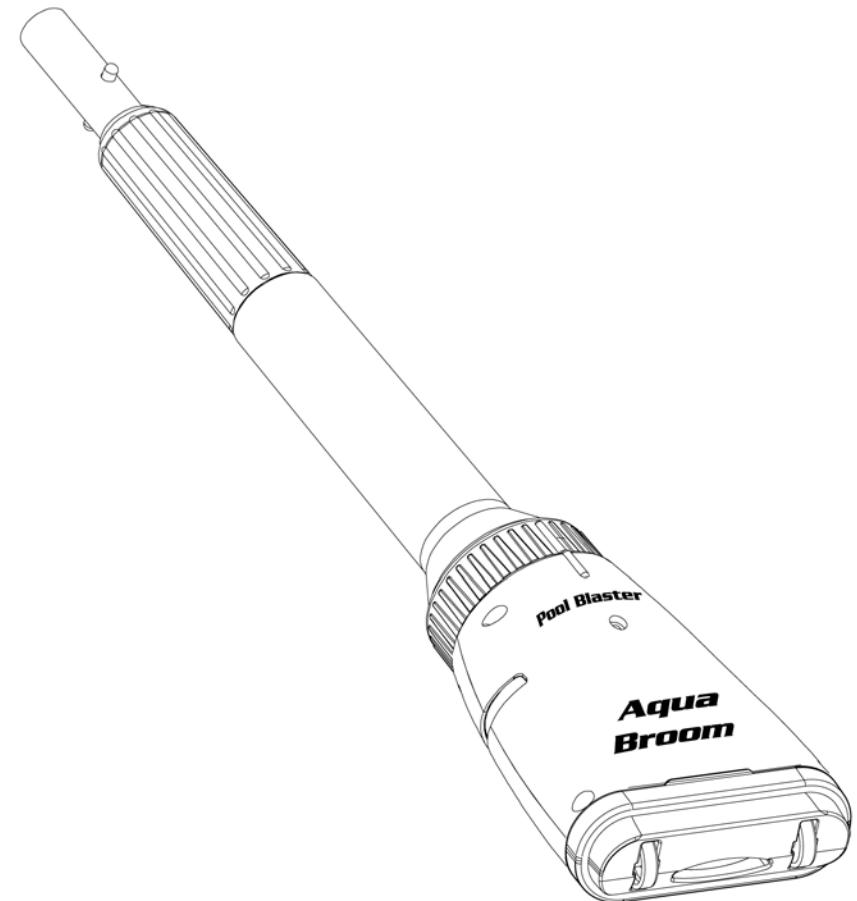

**POOL/SPA CLEANER™**  
USE AND CARE MANUAL



**Water Tech Corp**  
10 Alvin Ct.,  
East Brunswick, NJ 08816  
USA

Toll Free: (800) 298-8800

[info@WaterTechCorp.com](mailto:info@WaterTechCorp.com)  
[www.WaterTechCorp.com](http://www.WaterTechCorp.com)

**IMPORTANT:**  
**DO NOT RETURN THIS PRODUCT TO THE STORE**

Should you have any problems or questions concerning your product you should contact Water Tech's Customer Service division toll free at 1-800-298-8800 or visit [www.poolblaster.com](http://www.poolblaster.com).

Water Tech warrants this product for one year against any defects in material or workmanship under normal use and service, subject to conditions and limitations as described below.

Parts not covered under warranty: the filter bag and head cover are not warranted parts as these items require replacement in the normal course of use, due to normal wear.

This warranty covers only normal use for a residential swimming pool or spa. Damage, defect, malfunctions or any use which does not comply with the operator instructions, are excluded. Damage or any failure caused by repair, which is done by anyone other than a Water Tech authorized service center, shall not be covered.

**The motor housing is a factory sealed unit. The warranty will be considered void if opened by a non-authorized service center.**

To validate this warranty: the enclosed WARRANTY REGISTRATION CARD must be mailed within ten days of purchase. No warranty service will be performed unless Water Tech has received the WARRANTY REGISTRATION CARD.

The warranty obligations of Water Tech shall be limited to repair or replacement of the product. Water Tech, Inc. shall not be liable or responsible under any circumstances or in any amount for consequential or incidental damages, or for injury or damages to persons or property using or used in connection with the product or for loss of profits or other costs or expenses of any kind of character. There are no other warranties or representations by Water Tech other than as set forth herein, either expressed or implied and no person, firm or corporation is authorized to make any representation or honor any obligation in the name or on behalf of Water Tech except as stated herein.

Note from Water Tech .....	2
Important Tips .....	3
Service & Important Safeguards .....	4
Product Specifications/Diagram .....	6
Setting Up Your Cleaner .....	7
Using Your Cleaner .....	8
Using a Standard Pool Pole .....	9
Cleaning the Filter Bag .....	10
Common Questions .....	11
Warranty .....	12

**Q:** *Can my cleaner be run out of water?*

**A:** Yes, for a short period of time when you turn it on before submerging into your pool or spa. We recommend you turn the cleaner on just before submerging.

**Q:** *When I am cleaning my pool, how do I know when the cleaner is out of battery power?*

**A:** Most people can feel the cleaner is running through vibration in the vacuum pole. To be sure, you can lift it out of the water to hear if it is running or not.

**Q:** *How often should I clean out my cleaner filter bag?*

**A:** It is advisable to clean out your filter bag after each use, or whenever you notice the performance of your cleaner declining. For easy cleaning, the filter bag can be turned inside out and rinsed with a hose or in a sink. Do not wash it in a washing machine or with detergent. For more detailed instructions, see "Cleaning Your cleaner" instructions in this manual.

**Q:** *Where can I buy replacement parts?*

**A:** Look for original Water Tech replacement parts at your local retailer, visit [www.PoolBroom.com](http://www.PoolBroom.com), or call 1-800-298-8800 for more details.

**Q:** *Can I leave the cleaner in the pool when not in use?*

**A:** No. The cleaner should be removed from the pool and stored in a clean, dry place when not in use. This will increase the life of your cleaner and its accessories.

**Q:** *Can I leave the batteries in the cleaner all the time?*

**A:** For long term storage, it is best to remove batteries from chamber. For day-to-day use, you can leave the batteries in the cleaner. It is a good idea to periodically check the battery chamber for moisture and drain/air out if necessary.

**Q:** *How can I prevent sand and silt from escaping through the filter bag?*

**A:** A fine mesh vacuum bag, part no. BRFM, is available to purchase. Contact your retailer, visit [www.PoolBroom.com](http://www.PoolBroom.com), or call us at 1-800-298-8800.

**Q:** *What do I do if my cleaner does not vacuum?*

**A:** Make sure your cleaner is completely submerged in the water. The cleaner is only designed to vacuum water and will not vacuum air.

Check the following:

Make sure the filter bag and head cover are clear of debris that may be obstructing water flow.

Make sure the cleaner is turned on.

If none of the above help resolve the situation, please call our Customer Service Division at 1-800-298-8800.

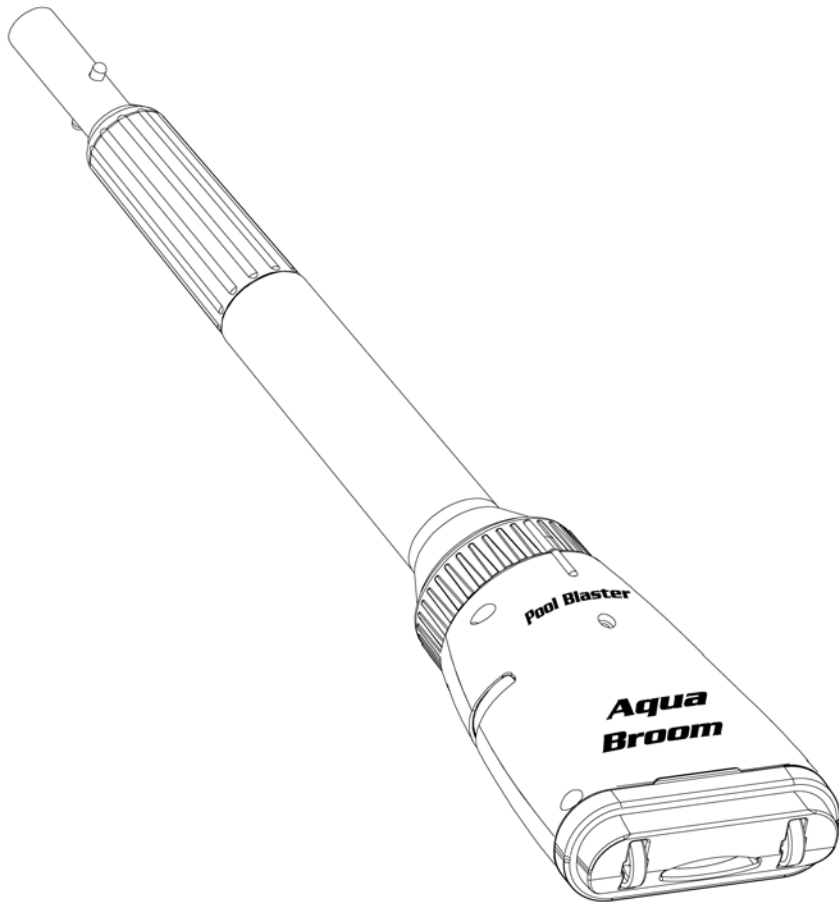

**CONGRATULATIONS** on your purchase of a top-quality Water Tech product, which has been thoroughly tested to meet our exacting quality control standards.

These guidelines and safeguards help insure that your new cleaner operates effectively. Please read all instructions carefully before using your cleaner.

## CLEANING THE REUSABLE FILTER BAG

For maximum cleaning efficiency, the filter bag/seal ring should be checked, emptied and cleaned after each use or whenever you notice the performance of your cleaner declining.

### To clean the filter bag

Make sure the unit is off before changing the filter or performing any other routine maintenance.

Remove the filter bag/seal by pulling firmly on the head cover

Invert the filter bag and rinse it with a garden hose or in a sink. Note: DO NOT clean in a washing machine or with detergent.

Re-insert the filter bag when finished and reattach head cover.

Note: Your reusable filter bag should be replaced if the seal ring is worn or if the bag is torn

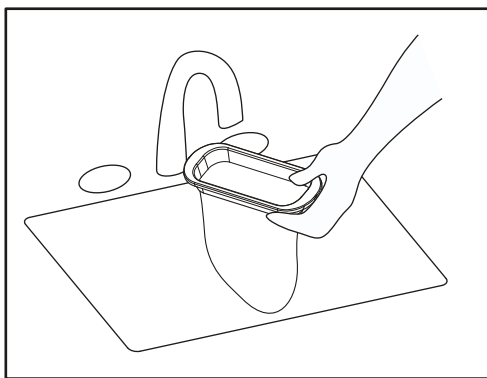

**⚠ WARNING:** Using your cleaner without the filter bag/seal in place will cause blockages in your machine and void your warranty.

**⚠ WARNING:** When servicing user serviceable parts, use only identical Water Tech replacement parts. Use of any other parts may create a hazard or cause product damage.

## IMPORTANT TIPS

**NOTE:** When not in use, your cleaner should be stored **indoors**, in a clean dry location sheltered from direct sunlight, extreme temperatures, and rain. Do not store the cleaner in a garage or anywhere the unit could freeze.

You may clean the cleaner body with soap and water. Avoid using solvents when cleaning plastic parts. Most plastics are susceptible to damage from various types of commercial solvents and may be damaged by their use. Use a clean cloth to remove dirt, dust, oil, grease, etc.

General maintenance of your cleaner requires you to occasionally clean off the O-rings on the head and add non-curing, non-toxic, high-temp, silicon lubricant/sealant, such as Dow Corning 111. This will ensure easier turning and a watertight seal. You can order lubricant directly from Water Tech (Part No. PBLUBE) or at your local pool & spa retailer.

### ⚠ CAUTION

Do not at any time let brake fluids, gasoline, petroleum-based products, penetrating oils, etc. come into contact with plastic parts. They contain chemicals that can damage, weaken or destroy plastic.

### ⚠ WARNING

Do not attempt to modify this tool or create accessories not approved for use with this tool. Any such alteration or modification is misuse and could result in a hazardous condition leading to possible serious injury. The motor is factory sealed in the motor box and **CANNOT BE REPLACED**. Do not attempt in any way to destroy or disassemble motor box or any of its components. Instead, take your cleaner to an authorized service center. Failure to follow these instructions may void your warranty agreement.

## SERVICE INFORMATION

**NOTE:** Any repairs requiring disassembly must be performed by a Water Tech Authorized Service Center. For the repair center nearest you, go to [www.poolblaster.com](http://www.poolblaster.com) or call us toll free at 1-800-298-8800. Unauthorized repairs will void the warranty.

## SERVICE & IMPORTANT SAFEGUARDS

### **⚠ WARNING:**

Any repairs requiring disassembly must be performed by a Water Tech Authorized Service Center. For the repair center nearest you, go to [www.poolblaster.com](http://www.poolblaster.com) or call us toll free at 1-800-298-8800. Unauthorized repairs will void the warranty.

### **⚠ WARNING:**

To reduce the risk of fire, electrical shock, injury or damage to your machine:

- ⚠ Opening the motor box exposes the motor components. Never let water enter here, as this will ruin your appliance and void the warranty.
- ⚠ Keep away from children.
- ⚠ Failure to comply with these warnings could result in fire and/or serious injury.
- ⚠ Do not use if unit is damaged in any way.
- ⚠ Use this product only for its intended use as described in this manual. Use only Water Tech accessories and filters.
- ⚠ NEVER LEAVE YOUR POOL BROOM IN WATER WHEN IT IS OFF OR HAS RUN OUT OF BATTERY POWER.
- ⚠ Do not use your cleaner for pool openings; the cleaner is designed for general maintenance of your pool or spa.
- ⚠ The cleaner is designed for underwater use only. Do not attempt to use your cleaner to clean anything other than your pool or spa. It is not intended for use as an all-purpose vacuum cleaner.
- ⚠ Close supervision is necessary when used near children. Do not allow this vacuum cleaner to be used as a toy.
- ⚠ This vacuum creates suction. Keep hair, loose clothing, fingers, and all parts of body away from openings and moving parts.

## USING A STANDARD POOL POLE

The handle on your cleaner is designed to accommodate any standard pole. Small poles (1" diameter) can be attached directly to the pool broom. If your pole has a larger (1 1/4" ) diameter, use the pole adapter included with your cleaner.

To attach a pole, simply press down on the alignment pins. Aligning the holes, slide the pole through the cuff, onto the cleaner, and release the clip.

**WARNING: DO NOT LEAN ON POLE OR USE POLE TO SUPPORT WEIGHT**

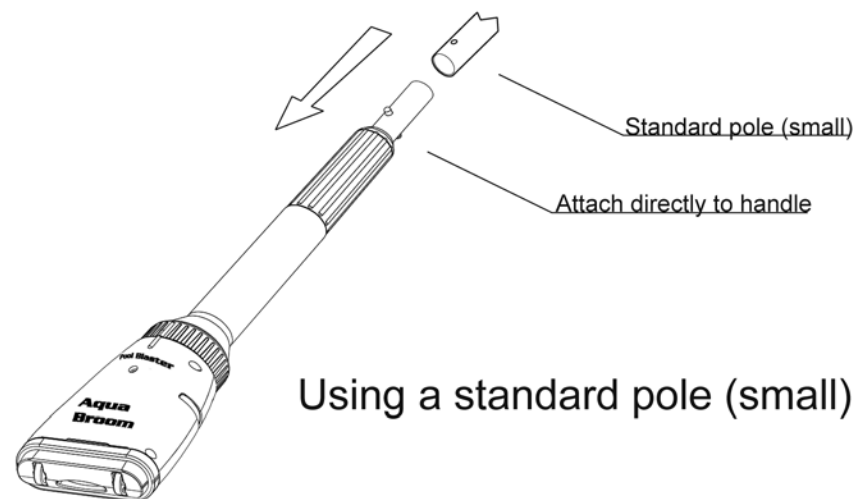

Using a standard pole (small)

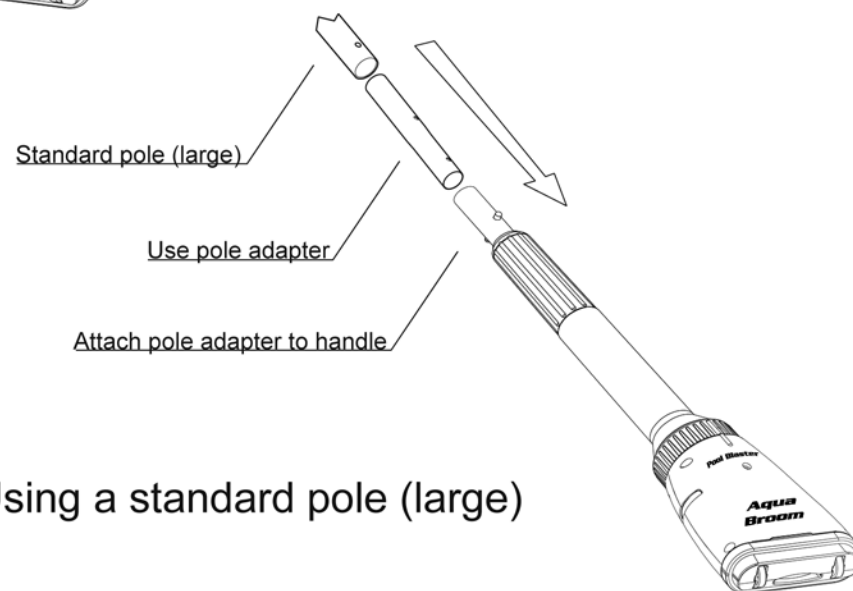

Using a standard pole (large)

## USING YOUR CLEANER

The Pool/Spa Cleaner is designed for general cleaning in all types of pools and spas. Use with caution for heavy cleaning - do not attempt to vacuum up large or sharp objects. The removable filter bag should be inspected and cleaned after each use.

Bring your cleaner to the side of the pool or spa and turn it on. The Pool/Spa Cleaner is in the "on" position when the head is rotated fully and the two indicator lines on the head and neck match up. **This must be done outside of the water before it is submerged.** Once the cleaner is on it can be completely submerged in water and is ready for use.

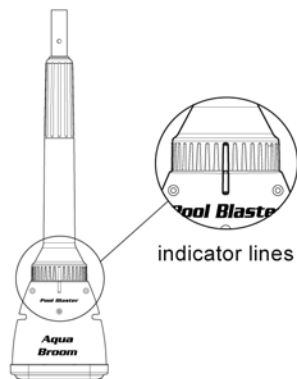

It is very important to make sure the unit is sealed and in the on position before submerging. **Do not submerge the unit until indicator lines meet.** Your cleaner should never be left in the water when off, as leakage can occur.

**NOTE: The cleaner is only designed to vacuum water and will not vacuum air. The cleaner will only work when completely submerged in water.**

### STORAGE:

A certain amount of space is left open in the Pool/Spa Cleaner body in order to ventilate and cool the motor and batteries. From time to time, water may enter the unit. It is very important to drain the unit completely between uses.

To store the Pool/Spa Cleaner, remove power head from battery chamber. Invert battery chamber to make sure any water in chamber is drained. (Hold batteries in place with your thumb so they don't fall out.) Leave power head and battery chamber separated until next use. For best care, remove batteries from chamber after each use.

- ⚠ Unit must be submerged in water to operate properly.
- ⚠ When not in use, store the Pool Broom **indoors**, in a clean, dry place. Do not leave underwater, in direct sunlight, or exposed to extreme temperatures.
- ⚠ For long term storage, remove batteries from your Pool Broom. Never leave batteries in Pool Broom for extended periods.
- ⚠ Do not use without vacuum bag and head cover in place.
- ⚠ Replace damaged filter bags promptly.
- ⚠ Avoid picking up hard, sharp objects with the vacuum. They may damage the vacuum and the filter bag.
- ⚠ Do not use to pick up toxic substances, flammable or combustible liquids such as gasoline, or operate in the presence of explosive or flammable fumes.
- ⚠ Never insert or drop any object into any opening on the device. Keep all openings free of leaves, rocks or anything that may reduce water flow.
- ⚠ Use extra care when cleaning on stairs.
- ⚠ Make sure the Pool Broom is in the 'off' position before cleaning or any other routine maintenance.
- ⚠ If vacuum cleaner is not working as it should, or has been dropped or damaged in any way, return it to a service center before using. Call 1-800-298-8800 or visit [www.poolblaster.com](http://www.poolblaster.com) for a center nearest you.
- ⚠ Leaks from a battery cell can occur under extreme conditions. If the battery liquid gets on the skin, wash immediately with water. If it gets in your eyes, immediately flush your eyes with a mild solution of baking soda and water and seek medical attention.

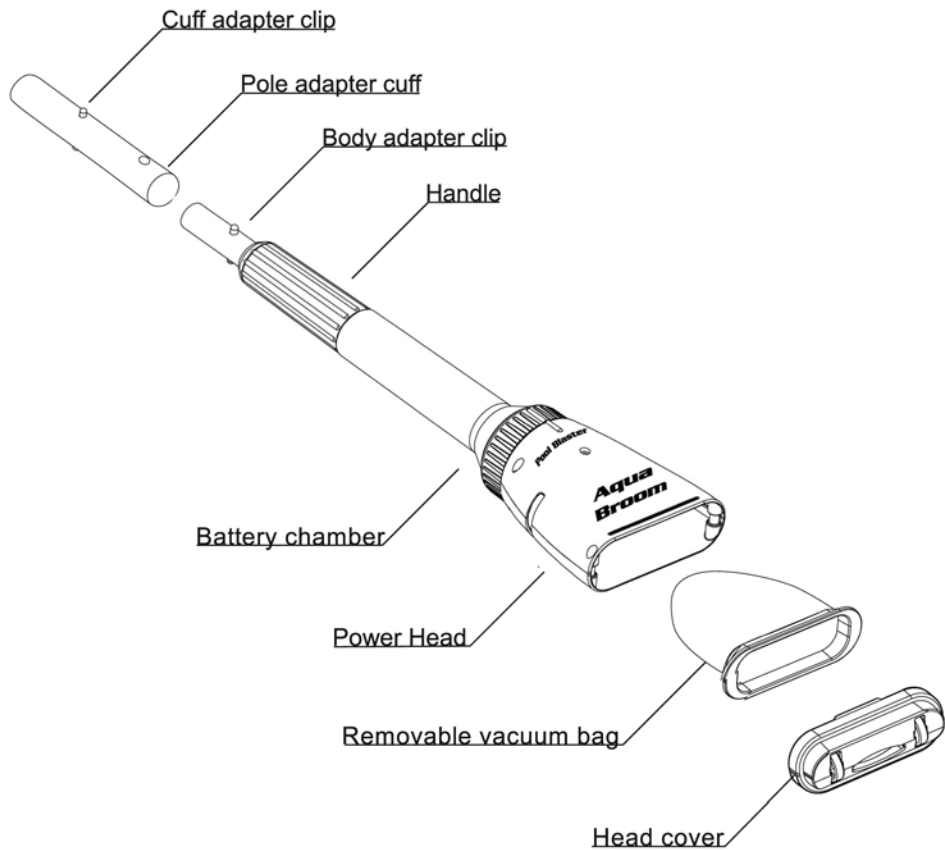

## PRODUCT SPECIFICATIONS

Item no.	Description	Qty.
BRHC	Head cover	1
BRAP	All-purpose filter bag	1
BRHD	Power head	1
BRBC	Battery chamber	1
BRBAC	Body adapter clip	1
BRPAC	Pole adapter clip	1
BRPACF	Pole adapter cuff	1
BRPOLE	Telescopic pole	1
PBW022MF	Microfilter bag	2

## ADDITIONAL AVAILABLE PARTS

Fine mesh vacuum bag, Part No. BRFM is available. To purchase, contact your retailer, visit [www.poolblaster.com](http://www.poolblaster.com), or call us toll free at 1-800-298-8800.

## SETTING UP YOUR CLEANER FOR USE

Your Pool/Spa Cleaner uses five D size batteries. To insert batteries, turn cleaner upside down. Remove head by gripping and turning counterclockwise. Insert batteries, **positive ends facing up** (towards head). Replace head on battery chamber and turn clockwise.

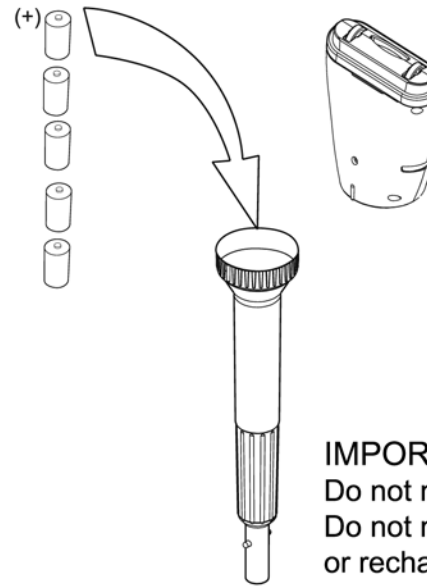

### IMPORTANT:

Do not mix old and new batteries.  
Do not mix alkaline, standard (Carbon-zinc) or rechargeable (Nickel-cadmium) batteries.

Check tightness of head cover and filter bag/seal. You are now ready to use the Pool/Spa cleaner in your pool or spa.

