

IMPORTANT: DO NOT RETURN THIS PRODUCT TO THE STORE

Should you have any problems or questions concerning your product you should contact Water Tech's Customer Service Division toll free in the U.S. at 1-800-298-8300 or via fax at 1-732-967-4070.

IMPORTANT : NE PAS RAMENER CE PRODUIT EN MAGASIN

En cas de problèmes ou de questions concernant votre produit, veuillez contacter la Division Service à la clientèle de Water Tech aux États-Unis au 1-33 (0)4 90 25 20 55 ou par télécopie au +1(0)33 490 25 20 59.

WICHTIG: DIESES PRODUKT KANN NICHT AN DAS GESCHÄFT

ZURÜCKGEGEBEN WERDEN

Bei Problemen oder Fragen bezüglich Ihres Produktes sollten Sie sich in den USA über Telefon unter der Rufnummer +33 (0)4 90 25 20 55 oder per Fax + 0033 490 25 20 59 mit der Water Tech-Kundendienstabteilung in Verbindung.

IMPORTANTE: NON RESTITUIRE IL PRODOTTO AL PUNTO VENDITA IN CUI È STATO EFFETTUATO L'ACQUISTO

In caso di problemi o quesiti riguardanti il prodotto, rivolgersi al reparto assistenza clienti (Customer Service Division) di Water Tech: tel. +33 (0)4 90 25 20 55, fax + 0033 490 25 20 59 (Stati Uniti).

IMPORTANTE: NO DEVUELVA ESTE PRODUCTO A LA TIENDA

Si tiene algún problema o preguntas respecto a su producto, lea el del: comunicarse con la División de Servicio al Cliente de Water Tech en los Estados Unidos llamando al +33 (0)4 90 25 20 55 o enviando un fax al +0033 490 25 20 59.

**Handheld underwater pool
& spa cleaner**
Use and Care Manual

Water Tech™

POOL BLASTER® CATFISH® PPV

NOTICE: THESE PRODUCTS ARE MANUFACTURED UNDER ONE OR MORE OF THE FOLLOWING PATENTS:

6,797,157; 6,939,460; 7,060,182;

D485,652; D518,253; D522,191 S;

OTHER U.S. AND INTERNATIONAL

PATENTS PENDING

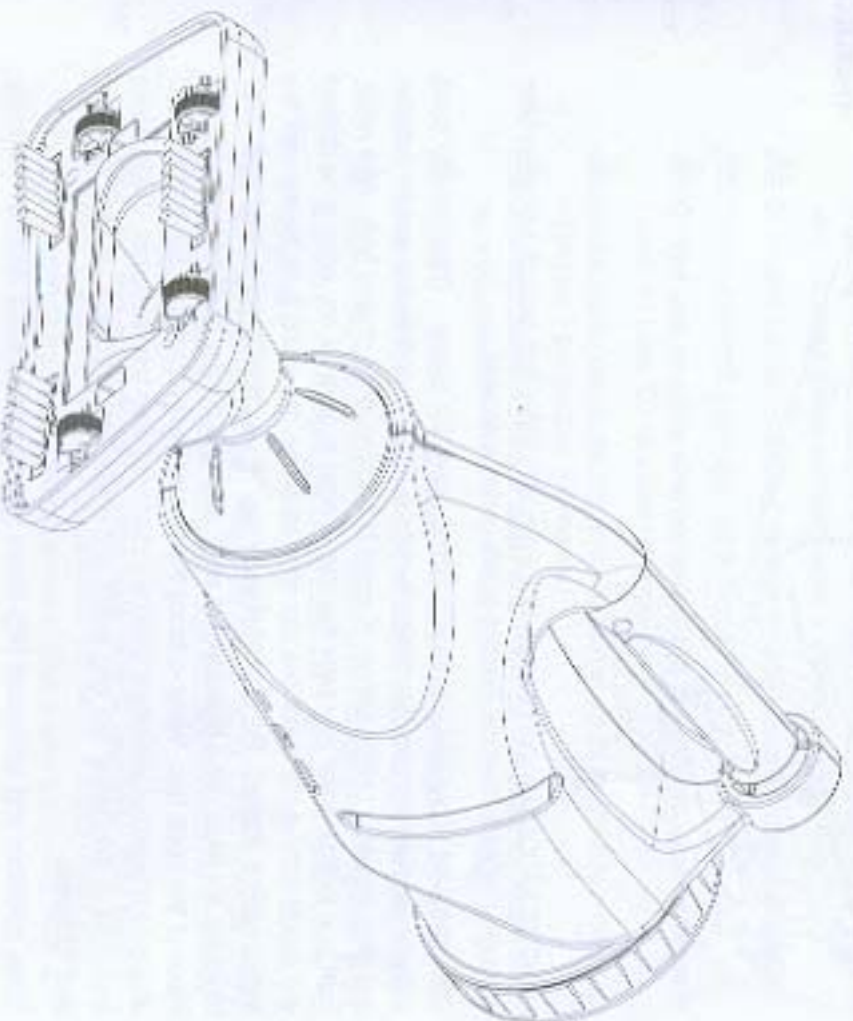

IMPORTANT:

DO NOT RETURN THIS PRODUCT TO THE STORE

Should you have any problems or questions concerning your product you should contact Water Tech's Customer Service Division toll free at 1-800-298-8300 or visit www.poolblaster.com

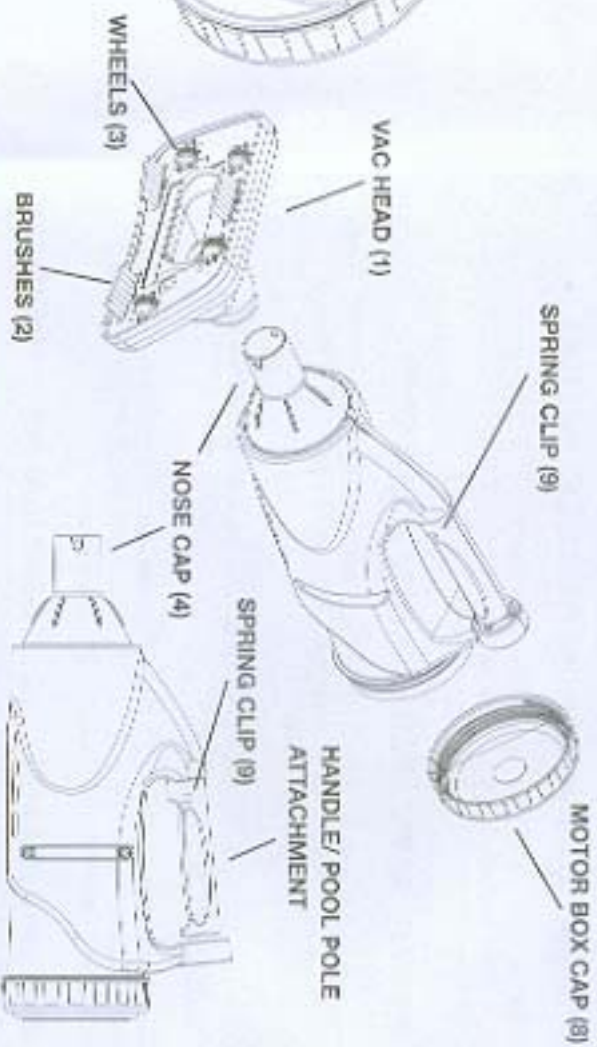
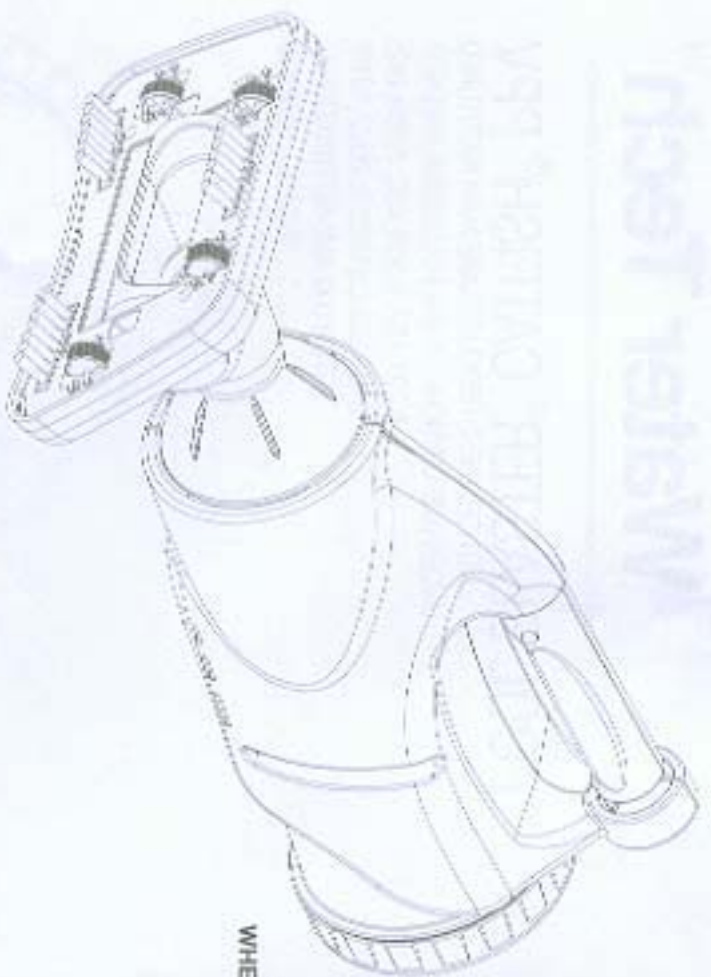

Product Specifications

HANDVAC

Model 7.2 VOL. DC

BATTERY

Charge (Using 120V 60 Hz AC only (US))

240 volts 50Hz AC only (International)

Charge Voltage: 6.7Vol

Switch On-Off

ITEM No.	DESCRIPTION	PART No.	QTY.
1	Vacuum Head	CAT006	1
2	Vacuum Head Brushes (for vinyl pools)	CAT049	3
3	Vacuum Head Wheels (for granite pools)	CAT050	4
4	Nose Cap	CAT002	1
5	All Purpose Filter Bag/Seal Ring	CAT022AP	1
6	Cleaner	CAT005	1
7	Battery Charger	CAT059*	1
8	Motor Box Cap	CAT015	1
9	Spring Clip	CAT041	1

ADDITIONAL PARTS:

- Sand & Silt bag (part No. CAT022SS)
 - Microfiber Bag (part No. CAT022MT) to be used in conjunction with Sand & Silt bag
 - Shallow Water Inlet Attachment (part No. PBA354)
 - Extension Attacher Tube (part No. CAT027) to fit smaller diameter telescopic poles.
 - * U.S. Charger (part No. CAT059)
 - * European 230V Charger (part No. CAT0738-13)
- To purchase parts either contact your reseller, go to www.poolbuster.com, or call us at (800)229-9800

CONGRATULATIONS on your purchase of a top-quality Water Tech product, which has been thoroughly tested to meet our exacting quality control standards.

State of the art Nickel-Metal Hydride batteries power the cleaner. These are the same batteries used in many portable phones. In order to properly maintain and cool the batteries and drive system, a certain amount of space is left open in the cleaner body. As a result, from time to time, water may enter the unit. In order to allow for any water to be drained you should remove the motor box cap after each use, and stand it on its end until the excess water is drained. The amount of water may be very small or not noticed at all. After removing any water use a blow dryer on warm setting to dry any moisture build-up on the inside of the motor box. Water entering the cleaner body presents no safety hazard and should be drained occasionally to avoid any chance of long-term corrosion. The batteries and motor in the cleaner are long lasting and proper care will help to prolong the life of your appliance.

These guidelines and safeguards help insure that your new cleaner operates effectively. Please read all instructions carefully before using your cleaner. Please take a few moments to review the following **IMPORTANT INFORMATION** before using this tool.

SERVICE & IMPORTANT SAFEGUARDS

▲ WARNING: Any repairs requiring disassembly should be performed by a Water Tech Authorized Service Center. For the repair center nearest you call us toll free at 1-800-298-8800.

▲ WARNING: To reduce the risk of fire, electrical shock, injury, or damage to your machine:

- ▲ Do not use it until it is damaged in any way.
- ▲ Use this product only for its intended use as described in this manual. Use only Water Tech accessories and filters.
- ▲ Never leave your cleaner plugged in for long term storage.
- ▲ **NEVER LEAVE YOUR CLEANER IN WATER WHEN IT IS "OFF" OR HAS RUN OUT OF BATTERY POWER.**
- ▲ Do not use your cleaner for pool openings. The cleaner is designed for general maintenance of your pool or spa.
- ▲ The cleaner is designed for underwater use only. Do not attempt to use your cleaner to clean anything other than your pool or spa. It is not intended for use as an all-purpose vacuum cleaner.
- ▲ Close supervision is necessary when used near children. Do not allow this vacuum cleaner to be used as a toy.
- ▲ This vacuum creates suction. Keep hair, loose clothing, fingers, and all parts of body away from openings and moving parts.
- ▲ Use must be submerged in water to operate properly.
- ▲ When not in use, store the cleaner indoors, in a clean, dry place. Do not leave underwater, in direct sunlight, or exposed to extreme temperatures.
- ▲ You can operate the cleaner without its vacuum head attachment, but when using the attachment, make sure that either the supplied wheels or brushes are inserted in place.
- ▲ Do not use without filter bag/seal ring and nose cap in place.
- ▲ Replace damaged filter bag/seal ring promptly.
- ▲ Avoid picking up hard, sharp objects with the vacuum. They may damage the vacuum and the filter bag.
- ▲ Do not use to pick up toxic substances, flammable or combustible liquids such as gasoline, or operate in the presence of explosive or flammable fumes.
- ▲ Never reset or drop any object into any opening on the device. Keep all openings free of leaves, rocks, or anything that may reduce water flow.

▲ Do not use on or near hot surfaces.

▲ Use extra care when cleaning on stairs.

▲ Make sure the cleaner is unplugged from the charger and in the "off" position before cleaning, filter change or any other routine maintenance.

▲ While cleaner is charging, do not handle with wet hands or without shoes.

▲ Only use the charger supplied to recharge this vacuum. Do not use the supplied charger with any other appliance.

▲ To protect against risk of electrical shock, do not put charger in water or other liquid.

▲ To avoid damage to the charger and cord, never carry the charger by the cord or yank to disconnect from an outlet. Instead, firmly grasp the charger body and pull to disconnect. Do not pull cord around sharp edges or corners.

▲ Do not allow the cord to hang over the edge of a table or counter or hand hot surfaces.

▲ Do not operate with a damaged cord or charger.

▲ **Do not use or store charger outdoors.** Charge your cleaner **indoors** in a clean, dry place. Do not expose charger to rain, or extreme temperatures.

▲ For best results, operate the charger in a location where the temperature is more than 50 degrees F but less than 100 degrees F.

▲ Disconnect charger from power supply when not in use, and before any routine cleaning or maintenance.

▲ The use of extension cords is not recommended. Plug the charger into a properly grounded standard electrical outlet (120V/60Hz US, 240 volts, 50Hz International) only.

▲ If vacuum cleaner is not working as it should, or has been dropped or damaged in any way, return it to a service center before using. Call 1-800-298-8800 for a center nearest you.

▲ This product contains a sealed nickel-metal hydride battery. Do not recharge battery as it will explode at high temperatures. Always dispose of the battery in accordance with your state law.

▲ Leaks from a battery cell can occur under extreme conditions. If the battery liquid gets on the skin, wash immediately with water. If it gets in your eyes, immediately flush your eyes with a mild solution of baking soda and water and seek medical attention.

USING YOUR CLEANER

The battery pack for your cleaner has been pre-filled in a low voltage condition. It should be charged overnight prior to use.

WARNING: The cleaner charger is for indoor use only.

WARNING: Do not expose charger to excessive moisture or extreme heat or cold. Charge battery only with the battery charger provided.

PRECAUTIONS:

- Make sure power supply is normal household voltage, 120 volts, 60 Hz (240 volts, 50Hz International), AC only.
- Do not handle cleaner while charging with wet hands or without shoes.
- Do not use or store your charger outdoors. Charge battery indoors in a clean dry place. For best results, your cleaner battery should be charged in a location where the temperature is above 50 degrees F and below 100 degrees F.

TO CHARGE

- Turn the cap on the back of your cleaner counterclockwise to expose the charging jack connector.

NOTE: When removing the motor box cap, it is normal to hear air escaping. The air noise has simply escaped from being held by the motor.

- Connect the lead from the charger to the charging jack on the cleaner.
- Connect the charger to the appropriate electrical outlet.
- After charging, ensure that the motor box cap is fully secure before attempting to use your cleaner.

CAUTION: Replace the Motor Box cap after charging. Placing cleaner in water without replacing the motor box cap will void your warranty.

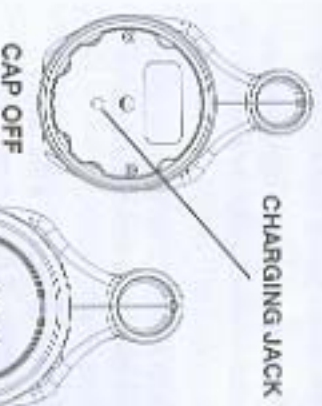

BATTERY LIFE

- The batteries are factory sealed in the motor box, and **CANNOT BE REPLACED**. Do not attempt in any way to destroy or disassemble motor box or any of its components. Under no circumstances should you attempt to open the battery pack and replace the batteries yourself. Your battery pack should give you many hours of use. If your motor batteries or charger stop working, take the cleaner to an authorized service center.
- **NEVER LEAVE** your cleaner plugged in for long term storage.

Setting up your cleaner for use

Please follow these instructions carefully:

- Place the cleaner on a stable and smooth surface.
- Place the filter bag inside the port on (A10022) into the cleaner, as shown in diagram. Make sure the rubber seal ring sits on the funnel. All of the filter bag must be inside the funnel to ensure the head closes fully.
- Put the motor cap (part no. (A10022)) on the tunnel, as shown. Align the lock tabs with the openings.
- Turn clockwise until it clicks back in place.

NOTE: You should not need to add excessive force in order to close. If you have trouble, make sure the filter bag is not between the seal and the motor cap or funnel and there are no other obstructions such as sand.

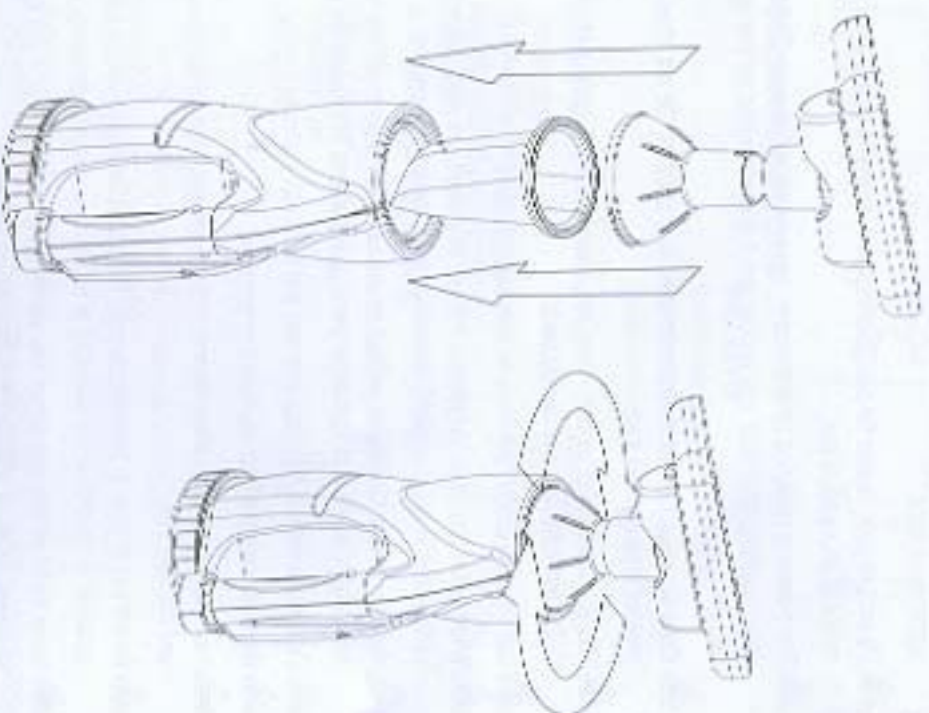

USING YOUR CLEANER

CAUTION: The cleaner is designed for **underwater use only**. Do not attempt to use your cleaner to clean anything other than your pool or spa. It is not intended for use as an all-purpose vacuum cleaner. Unit must be submerged in water to operate properly. Maximum operating temperature is between +5°C (41°F) and +40°C (104°F). Maximum operating depth is 4 meters (13 ft).

- ▲ Close supervision is necessary when used near children. Do not allow the vacuum cleaner to be used as a toy.
- ▲ This vacuum creates suction. Keep hair, loose clothing, fingers, and all parts of body away from openings and moving parts.
- ▲ Avoid picking up hard, sharp objects with the vacuum. They may damage the vacuum and the filter bag.
- ▲ Do not use without the bag/seal ring and nose cap in place.
- ▲ Replace damaged filter bag/seal ring promptly.
- ▲ Do not use your cleaner to pick up toxic substances, flammable or combustible liquids such as gasoline, or operate in the presence of cryogenic or flammable gases.
- ▲ Never insert or drop any object into any opening on the device. Do not use with any opening blocked. Keep all openings free of leaves, rocks, or anything that may reduce water flow.
- ▲ Do not use on or near hot surfaces.
- ▲ Use extra care when cleaning on stairs.
- ▲ When not in use, store the cleaner indoors in a clean, dry place. Do not leave in direct sunlight, underwater, or exposed to extreme temperatures.
- ▲ In order for your cleaner to operate properly, both side vents must be submerged completely (at least 10").

Your cleaner is designed for use in 3 different ways to vacuum your pool or spa:

- A. Vacuum using the handle and the vacuum head removed.
- B. Vacuum using the handle and attached vacuum head, with either wheel or brush attachments depending on pool type.
- C. Vacuum using a standard vacuum pole (not supplied) with the attached vacuum head.



WARNING: Never use your cleaner without the filter bag/seal ring and nose cap properly in place. Doing so will **VOID** the warranty.

Using a standard pole

The handle on your cleaner is designed to accommodate any standard pole. To attach a pole, simply press down on the alignment pins on the pole (retaining spring clip). Aligning the hook, slide the pole through the curl, onto the cleaner and release the clip.

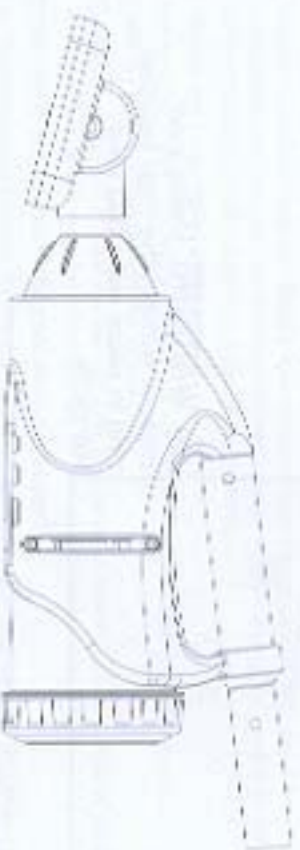

WARNING: Do not lean on pole or use pole to support weight.

WARNING: Never put the cleaner in water while the charging jack is connected.

WARNING: To keep water out of the motor box, before submerging make sure the motor box cap is fully secured by turning all the way until the arrow is aligned to the "Lock" symbol.

Once your cleaner is set up for use, getting just it in your pool or spa.

- Bring your cleaner to the side of the Pool or Spa and turn it on by depressing the power button. This must be done outside of the water before it is submerged.
- Once the cleaner is "On" it can be completely submerged in water and is ready for use.
- This appliance is designed to be in water only when in the "On" position and has battery power. Excessive bubbling can occur when not running and void the warranty. Never leave your cleaner in the water when it is off.

WARNING: If any parts are missing, do not operate until the missing parts are replaced. Failure to do so could result in serious injury.

NOTE: To remove the unit from the pool: Lift from pool with the nose facing up to allow the water to escape from the back and sides.

NOTE: The cleaner is only designed to vacuum water and will not vacuum air. The cleaner will only work when completely submerged in water and the air is out of funnel.

Cleaning the reusable filter bag

For maximum cleaning efficiency, the filter bag seal ring should be checked, squeezed, and cleaned after each use or when you notice the performance of your cleaner declining.

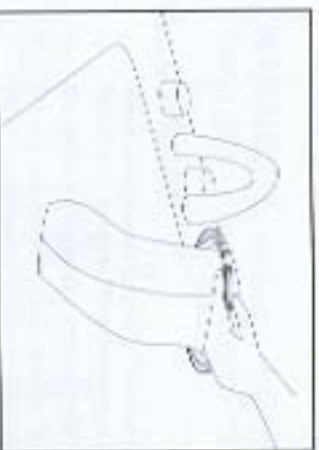

WARNING: Using your cleaner without the filter bag/seal ring in place will VOID your warranty.

To clean the filter bag/seal ring

- Using the cleaner from the changing outlet before changing the filter or performing any other routine maintenance.
- Place the cleaner on its end from the vacuum pole, if attached.
- Turn nose cap counter clockwise, in unlock.
- Remove the filter bag/seal ring by pulling it out of the barrel (see diagram).
- Insert the filter bag/seal ring and nose with a gentle force or in a sink. Never do not clean in a washing machine or with detergent.
- Re-insert the filter bag when finished.
- Note: Your reusable filter bag should be replaced if the seal ring is worn or if the bag is torn.

WARNING: When servicing user serviceable parts, use only identical Water Tech replacement parts. Use of any other parts may create a hazard or cause product damage.

WARNING: Opening the motor box cap exposes the motor components. Never let water enter here, as this will ruin your appliance and void the warranty.

WARNING: Keep away from children. Failure to comply with these warnings could result in fire and/or serious injury.

Important Tips:

- Store your cleaner in a clean, dry place when not in use. Do not leave it underwater in direct sunlight or exposed to extreme heat or cold.
- You may clean the cleaner body with soap and water. Avoid using solvents when cleaning plastic parts. Most plastics are susceptible to damage from various types of commercial solvents and may be damaged by their use. Use clean cloths to remove dirt, dust, oil, grease etc.
- The motor box cap should be periodically lubricated with a silicon-based grease.

CAUTION: Do not at any time let brake fluids, gasoline, petroleum-based products, penetrating oils, etc. come in contact with plastic parts. They contain chemicals that can damage, weaken, or destroy plastic.

WARNING: Do not attempt to modify this tool or create accessories not approved for use with this tool. Any such alteration or modification is misuse and could result in a hazardous condition leading to possible serious injury. The batteries and motor are factory sealed in the motor box and **CANNOT BE REPAIRED**. Do not attempt in any way to destroy or disassemble motor box or any of its components. Instead, take your cleaner to an authorized service center. Failure to follow these instructions may void your warranty agreement.

- General maintenance of your cleaner requires you occasionally clean off the O-rings on the motor box cap and add silicone lubricant/sealant. This will ensure regular turning and a water-tight seal. This lubricant can be ordered directly from Water Tech (Part No. PSL10B) or at your local pool & spa retailer.
- In the Nose Cap (Part No. CAT002) there is a Flapper Valve. To keep the Nose Cap Flapper Valve moving freely, clean the valve after every use. This will help to keep dirt inside the cleaner after the cleaner is removed from the pool.

SERVICE INFORMATION

NOTE: Any repair requiring disassembly must be performed by a Water Tech Authorized Service Center. For the repair center nearest you, go to www.poolcleaner.com, or call us toll free at 1-800-258-8890. Unauthorized repairs will void the warranty.

NOTE: Remove cleaner from charge before storage. When not in use, your cleaner should be stored indoors, in a clean, dry location sheltered from direct sunlight, extreme temperatures and rain. Do not store the cleaner in a garage or anywhere the unit could freeze. Storing the cleaner in areas of high humidity can affect battery performance over time.

Long Term Storage

Follow the above storage instructions and unplug the charger from the electrical outlet.

When charging for the first time after long term storage, your cleaner may take 4-5 weeks before full run time is achieved.

